



JW MARRIOTT

FRANKFURT

INSPIRED EVENTS.
THOUGHTFULLY CRAFTED.





JW MARRIOTT
FRANKFURT

INSPIRED EVENTS. THOUGHTFULLY CRAFTED.

The JW Marriott Hotel Frankfurt is located in an absolute prime location and offers the amenities of the luxury brand of Marriott International directly in the heart of the cosmopolitan city. Guests can expect excellent service, exquisite dining options and a breathtaking view over Frankfurt. The JW Marriott Hotel Frankfurt is a retreat amid a fast-paced world, combining the tranquility of a modern building with the amenities of a luxury hotel.

EVENTS by JW

JW MARRIOTT® HOTEL FRANKFURT
 Thurn-und-Taxis-Platz 2
 60313 Frankfurt
 Germany
 Tel +49 69 2972370
meeting@jwfrankfurt.com
jwfrankfurt.com

ACCOMMODATIONS

The 218 spacious rooms and suites at the JW Marriott Hotel Frankfurt offer breathtaking views of the city, Frankfurt skyline, and the Taunus mountains through their floor-to-ceiling windows. All rooms feature a Nespresso coffee machine and a large painting by contemporary artist Hartwig Ebersbach. Special highlights include the Senator Suite and the Presidential Suite, spanning 105 m² and 220 m², respectively. Both suites feature separate living rooms, while the Presidential Suite also includes a large study and sauna, offering a sensational view of the Frankfurt skyline.

RESTAURANT & BAR

The HERITAGE Frankfurt PopUp team serves modern interpretations of cuisine that invite you to share. Excellent food, signature drinks, cool cocktail creations and casually perfect service - not only hotel guests, but also Frankfurt locals enjoy all of it. Whether it's an extensive breakfast, lunch or dinner with friends - the HERITAGE Frankfurt PopUp offers the perfect ambience for any occasion.

RECREATION & LEISURE

The luxurious spa at the JW Marriott Hotel Frankfurt offers personalized treatments and separate saunas for guests to nourish their souls. All guests enjoy free admittance to the directly connected Fitness First gym including swimming pool.

ATTRACTIONS

With direct access to the Zeil shopping district, walking distance to the famous Goethestrasse and only a 20-minute drive from Frankfurt International Airport, guests have easy access to the business districts, the Main River, all museums and sights.

MEETING FACILITIES

The five event spaces, including the Crystal Ballroom with its spacious foyer, offer a total area of 793 m². With its perfect location in the city center, the JW Marriott Hotel Frankfurt

is mindful of providing an ideal setting for private celebrations, conferences, or corporate events. Creative catering options, state-of-the-art technology, and a focus on nourishing the attendees' needs contribute to the success of every event and are tailored to individual preferences. JW Marriott Frankfurt creates a welcoming atmosphere where guests enjoy coming together.

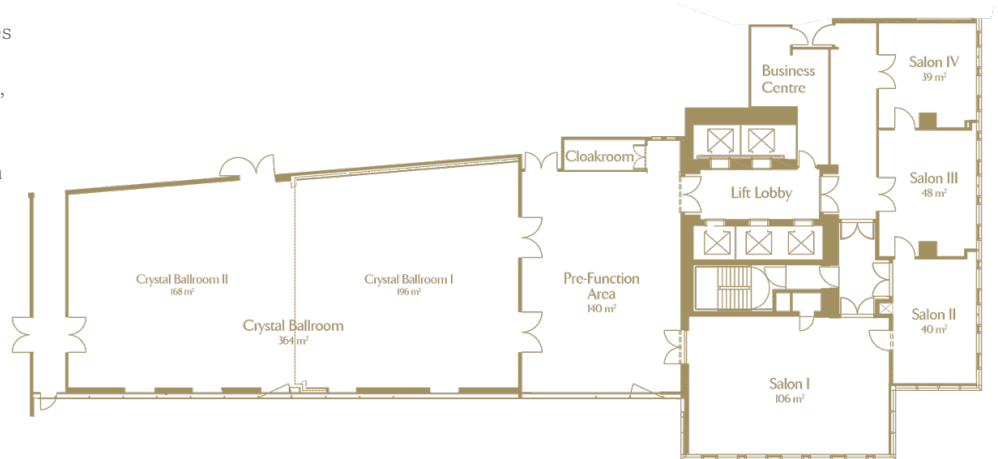

	DIMENSIONS		CAPACITY					
	LxWxH	SQ FT	THEATER	CLASSROOM	U-SHAPE	CABARET	CONFERENCE	BANQUET
Crystal Ballroom I & II	92'x43'x11'	3918	180	156	2x 30	70-80	2x 50	140
Crystal Ballroom I	46'x46'x11'	2110	80	60	38	42	2x 24	90
Crystal Ballroom II	46'x33'x11'	1808	60	50	30	36	2x 20	90
Pre-Function Area	46'x32,8'x11'	1507	-	-	-	-	-	-
Salon I	41'x27,9'x11'	1141	50	30	20	30	20	40
Salon II	24,6'x17'x11'	431	16	12	10	6	10	10
Salon III	26,2'x19,7'x11'	517	20	16	16	10	16	16
Salon IV	22'x19,7'x11'	420	16	12	8	6	8	10
Foyer Salons	60,4'x8,5'x11'	549	-	-	-	-	-	-